

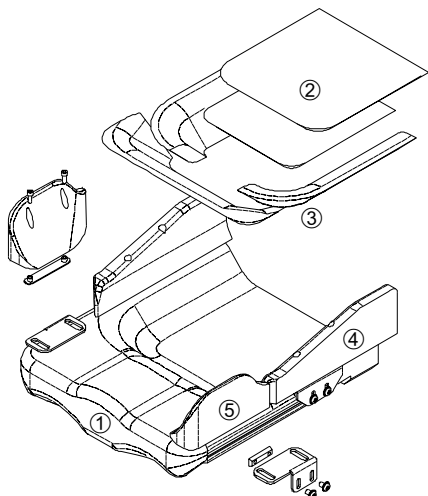

**ADJUSTABLE CONTOUR SEAT** (includes set of anterior well reducers<sup>4</sup>; one pair lateral well reducers & Rubatex™ inner cover)<sup>1</sup>



① **SEAT WIDTH AND DEPTH** (seat width is 1" narrower than frame width)<sup>2</sup>

- 10" Frame Width \$758 ea  
Seat Depth  8"-12"  9"-14"
- 12" Frame Width \$758 ea  
Seat Depth  8"-12"  9"-14"  11"-16"
- 14" Frame Width \$848 ea  
Seat Depth  9"-14"  11"-16"  13"-18"
- 16" Frame Width \$848 ea  
Seat Depth  11"-16"  13"-18"  15"-20"
- 18" Frame Width \$848 ea  
Seat Depth  11"-16"  13"-18"  15"-20"

② **WELL INSERTS** (Each layer is 1/2" thick, total well depth 1 1/2")

	POLY \$27 ea layer				CONFORM \$54 ea layer			
LAYER	Soft	MedSoft	Medium	Firm	Soft	MedSoft	Medium	Firm
Top								
Middle								
Bottom								

- Outer Cover** (indicate color) Qty
- Incontinent \_\_\_\_\_ \$ 90 ea \_\_\_\_\_
  - AirExchange™ (Black only) \$ 90 ea \_\_\_\_\_
  - Naugahyde \_\_\_\_\_ \$ 90 ea \_\_\_\_\_

- Fluid Pad \$390 ea
- Omit well inserts
- ③  Additional Lateral Well Reducers \$ 93 ea Qty. \_\_\_\_ Left \_\_\_\_ Right

④ **ADJUSTABLE CONTOUR LATERAL PELVIC SUPPORTS** – \$357 pr (see table A)

- |  |                                    |
|--|------------------------------------|
| Fixed Brackets                         | Contour Pads                       |
| <input type="checkbox"/> 0"-1/2" Inset | <input type="checkbox"/> 2" Height |
| <input type="checkbox"/> 1/2"-1" Inset | <input type="checkbox"/> 3" Height |

⑤ **ADJUSTABLE CONTOUR LATERAL THIGH SUPPORTS** – \$357 pr (see table B)

- |  |                                    |
|--|------------------------------------|
| Fixed Brackets                                   | Contour Pads                       |
| <input type="checkbox"/> 1/2" Offset -1/2" Inset | <input type="checkbox"/> 2" Height |
| <input type="checkbox"/> 0"-1" Inset             | <input type="checkbox"/> 3" Height |

**ANTERIOR PELVIC SUPPORTS** (Hip Belt)

- |   |   |   |
|---|---|---|
| Side-Squeeze Buckle   | Dual Adj. Side -Squeeze Buckle                                | Aircraft Lift-Latch Buckle                                      |
| <input type="checkbox"/> 1" Strap Width - Nonpadded \$55 ea     | <input type="checkbox"/> 1" Strap Width - Padded \$115 ea     | <input type="checkbox"/> 2" Strap Width \$152 ea                |
| <input type="checkbox"/> 1 1/2" Strap Width - Nonpadded \$63 ea | <input type="checkbox"/> 1 1/2" Strap Width - Padded \$134 ea | <input type="checkbox"/> 2" Strap Width With Quad Loop \$170 ea |
| <input type="checkbox"/> 2" Strap Width - Nonpadded \$71 ea     | <input type="checkbox"/> 2" Strap Width - Padded \$152 ea     | <input type="checkbox"/> 2" Strap Width - Padded \$206 ea       |

**FLIP-DOWN MEDIAL THIGH SUPPORT** (Abductors– includes flipdown bracket, pads and cover) \$697 pr

- Pad Size  Additional Cover \$72
- 3" H x 4" L  4" H x 6" L
  - 3" H x 6" L  4" H x 8" L

**FOOT POSITIONER - SHOE HOLDERS** – \$268 pair (with Velcro® Straps only)

- |                                 | Toe Width | Heel Width | Length |                                      | Toe Width | Heel Width | Length |
|---------------------------------|-----------|------------|--------|--------------------------------------|-----------|------------|--------|
| <input type="checkbox"/> Small  | 2.5"      | 2.5"       | 5.5"   | <input type="checkbox"/> Large       | 4.5"      | 3.5"       | 10.25" |
| <input type="checkbox"/> Medium | 3.75"     | 3.5"       | 8"     | <input type="checkbox"/> Extra Large | 5.75"     | 3.75"      | 11"    |

**SEAT ATTACHING HARDWARE KITS**

- Height Adjustable Quick Mount<sup>5\*</sup> \$535 kit
- Standard Quick Mount<sup>5,6\*</sup> \$357 kit
- Snaptite<sup>7</sup> with collars \$402 kit
- TriCell™ \$170 kit  
(For rectangular or square tubing and S-626)

Seat rail diameter \_\_\_\_\_

\*Transit Option approved. 1" diameter only tube

**ADJUSTABLE CONTOUR BACK** (includes foam insert and choice of cover)<sup>1</sup>

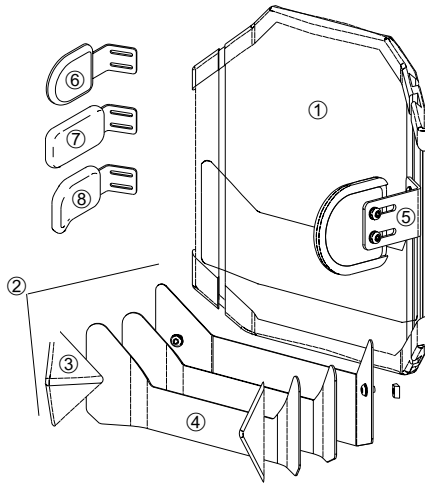

**Custom Embroidery** (12 letter limit, not available on AirExchange™ back cover)

Custom Embroidery N/C

Name: \_\_\_\_\_

Color: \_\_\_\_\_

Or match frame color

**Cover Style** (indicate color)

Incontinent \_\_\_\_\_ Qty \_\_\_\_\_

AirExchange™ (Black only. Embroidery not available) Qty \_\_\_\_\_

Naugahyde \_\_\_\_\_ Qty \_\_\_\_\_

Spinal Fluid Pad (incontinent cover only) \$ \_\_\_\_\_

**Accessories**

Shoulder Harness Guides Kit \$ 54 ea Qty \_\_\_\_\_

Universal Headrest Mounting Plate \$ 90 ea Qty \_\_\_\_\_

(necessary to mount any headrest)

**① BACK WIDTH & HEIGHT** (back width is 1" narrower than frame width)<sup>2</sup>

- |  |           |   |           |   |           |
|--|-----------|---|-----------|---|-----------|
| <input type="checkbox"/> 10" Frame Width<br>Height <input type="checkbox"/> 10" <input type="checkbox"/> 12" <input type="checkbox"/> 14"                              | \$ 714 ea | <input type="checkbox"/> 14" Frame Width<br>Height <input type="checkbox"/> 12" <input type="checkbox"/> 14" <input type="checkbox"/> 16" <input type="checkbox"/> 18" <input type="checkbox"/> 20" | \$ 804 ea | <input type="checkbox"/> 18" Frame Width<br>Height <input type="checkbox"/> 14" <input type="checkbox"/> 16" <input type="checkbox"/> 18" <input type="checkbox"/> 20" <input type="checkbox"/> 22" | \$ 890 ea |
| <input type="checkbox"/> 12" Frame Width<br>Height <input type="checkbox"/> 12" <input type="checkbox"/> 14" <input type="checkbox"/> 16" <input type="checkbox"/> 18" | \$ 714 ea | <input type="checkbox"/> 16" Frame Width<br>Height <input type="checkbox"/> 14" <input type="checkbox"/> 16" <input type="checkbox"/> 18" <input type="checkbox"/> 20" <input type="checkbox"/> 22" | \$ 804 ea |   |           |

**② LATERAL/POSTERIOR PELVIC SUPPORT KIT**

- Kit \$178 ea  
(includes mounting plate; one narrow and one wide posterior contour strip & one pair lateral pyramids)  
(see ③ and ④)

**③ LATERAL PYRAMIDS**

- Small  Large

**④ ADDITIONAL POSTERIOR CONTOUR STRIP** \$ 36 ea

Qty. \_\_\_\_\_ Narrow (1 3/4") \_\_\_\_\_ Wide (2 1/4")

**⑤ LATERAL THORACIC SUPPORTS**

Hardware Style

- Fixed \$142 pr  
 Swing-away \$535 pr

Internal Mounting brackets

- Straight to 1" inset  
 1"-2" inset

External mounting brackets<sup>3</sup>

- Straight  
 1" inset  
 2" inset

Miscellaneous

- Bracket Spacers (1/4" thick each) \$9 ea Qty \_\_\_\_\_  
 Winter/Summer Adjustment Kit \$134 pr  
(only available on external mounting bracket)

**THORACIC PADS** (Select from ⑥, ⑦ or ⑧) (All pads will work on any bracket)

- |  |  |   |
|--|--|---|
| <b>⑥</b> <input type="checkbox"/> Paddle Style \$178 pr<br>(includes AirExchange cover)<br>Size <input type="checkbox"/> 4 x 4 <input type="checkbox"/> 5 x 5 <input type="checkbox"/> 6 x 6 | <b>⑦</b> <input type="checkbox"/> Flat Style                             | <b>⑧</b> <input type="checkbox"/> Curved Style      |
|  | Pad Size (flat or curved) \$178 pr                                       | Pad Covers \$68 pr<br>(optional for flat or curved) |
|  | <input type="checkbox"/> 3"H x 4" L <input type="checkbox"/> 4" H x 4" L | <input type="checkbox"/> Rubatex                    |
|  | <input type="checkbox"/> 3"H x 5" L <input type="checkbox"/> 4" H x 5" L | <input type="checkbox"/> Naugahyde                  |
|  | <input type="checkbox"/> 3"H x 6" L <input type="checkbox"/> 4" H x 6" L | <input type="checkbox"/> Incontinent                |
|  | Custom Size:<br>Height _____ Length _____ \$255 pr                       |   |

**HEAD SUPPORTS\*** Choose style, pad size, pad cover, hardware and vertical adjustment

- |  |   |   |
|--|---|---|
| <b>1. Style- Standard Rubatex</b>  | <b>2. Pads - Posterior</b> (1 and 3 Pad Only)     | <b>4. Mounting Hardware</b>   |
| <input type="checkbox"/> Single Pad \$357  | <input type="checkbox"/> Small (3 1/2" x 7 3/4")  | Slide-In  |
| <input type="checkbox"/> Three Pad \$626<br>(1 posterior & 2 lateral occipital pads) | <input type="checkbox"/> Large (5 1/2" x 10 1/2") | <input type="checkbox"/> Short <input type="checkbox"/> Long                                      |
| <input type="checkbox"/> Three Pad Rotational \$1161                                 | <b>Occipital Pad Offset</b> (3 and 4 Pad Only)    | <b>5. Flip-Back</b> \$162 Add'l   |
| <input type="checkbox"/> Four Pad \$804  | <input type="checkbox"/> Standard                 | <input type="checkbox"/> Extra short <input type="checkbox"/> Short <input type="checkbox"/> Long |
| <input type="checkbox"/> Four Pad Rotational \$1340                                  | <input type="checkbox"/> Junior                   |   |
| <input type="checkbox"/> Full Width Planar (Includes Hardware) \$313                 | <b>3. Pad Covers</b>                              |   |
| Height: _____  | <input type="checkbox"/> Rubatex (Std)            |   |
| Length: _____  | <input type="checkbox"/> Naugahyde                |   |
|  | <input type="checkbox"/> Incontinent              |   |

\*Head support requires universal headrest mounting plate

**ANTERIOR TRUNK SUPPORTS**

Shoulder Harness (requires shoulder harness guide kit)

- Small  Medium  Large \$178 ea

Chest Strap

- Medium  Large \$63 ea

**BACK ATTACHING HARDWARE KITS**

- |   |                                |
|---|--------------------------------|
| <input type="checkbox"/> Adj. Quick Mount* <sup>5</sup> \$447 Kit | Upper back tube diameter _____ |
| <input type="checkbox"/> Snaptite with collars \$403 Kit          | Lower back tube diameter _____ |
| <input type="checkbox"/> TriCell™ (T45) \$170 Kit                 |                                |

\*Transit Option Approved 1" diameter only tube

**TABLE A****Width Between Lateral Pelvic Supports**

Frame Size	1/2" Inset- 0"	1"-1/2" Inset
10"	6.75"-7.75"	5.75"-6.75"
12"	8.75"-9.75"	7.75"-8.75"
14"	10.75"-11.75"	9.75"-10.75"
16"	12.75"-13.75"	11.75"-12.75"

**TABLE B****Width Between Lateral Thigh Supports**

Frame Size	1"Inset-0"	1/2" Inset-1/2"Offset
10"	6.5"-8.5"	7.5"-9.5"
12"	8.5"-10.5"	9.5"-11.5"
14"	10.5"-12.5"	11.5"-13.5"
16"	12.5"-14.5"	13.5"-15.5"

Specifications Subject to Change Without Notice.

**Fit System Footnotes:**

**Notes:** When ordering an insert with your Quickie 2 wheelchair, you must order medium or high push handles. Low push handles are not available.

1. Weight limit: 150 lb. Adjustable Contour System, 250 lb. on 18" wide system.
2. For odd size frame widths, order Fit system for next size down (e.g. 13" frame width would order Fit system for 12" frame width).  
Insert will be 2" narrower than frame.
3. Trunk pads may interfere with flip-up armrests.
4. Number of anterior well reducers will vary based on seat depth ordered.
5. Not available in 3/4" diameter.
6. Standard Quick Mount hardware is not available on any chair with a cross strut that is level with the seat rail. Must use Height Adjustable Quick Mount.
7. Snaptite hardware may interfere with wheel locks on all Zippie 2 wheelchairs with kids frame length and regular frame length with 24" rear wheels.

<b>TOTAL \$</b> _____
-----------------------