



The Talon™ Back Support

Talon

- Back system of choice for clients requiring minimal trunk support
- Fully adjustable
- Easy to mount
- Extremely lightweight



Talon

- Spinal curvature
- Mounting hardware
- Shell
- Cushion
- Cover



Spinal Curves

- Same in sitting as in standing
- Pelvic anterior tilt
- Control with stable pelvis, not mobile lumbar
- Bad posture is not the enemy- ***TIME IS!***

Lateral (Side) Spinal Column

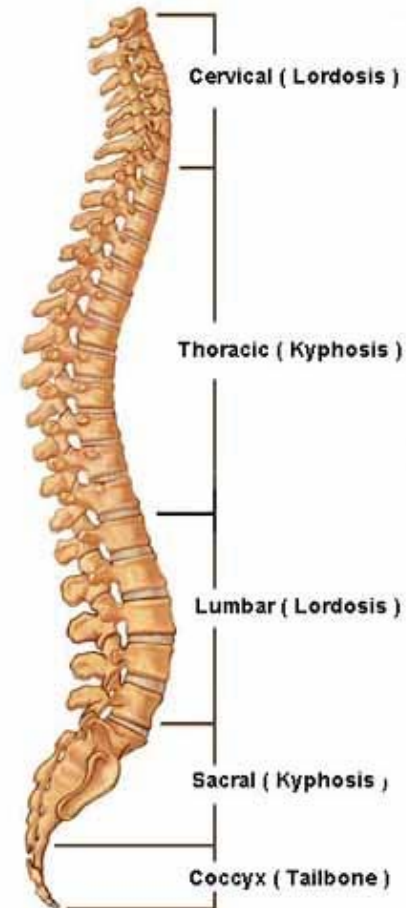



Mounting Hardware

- Back Height
- Back Angle
- Bracket attachment



Back Height

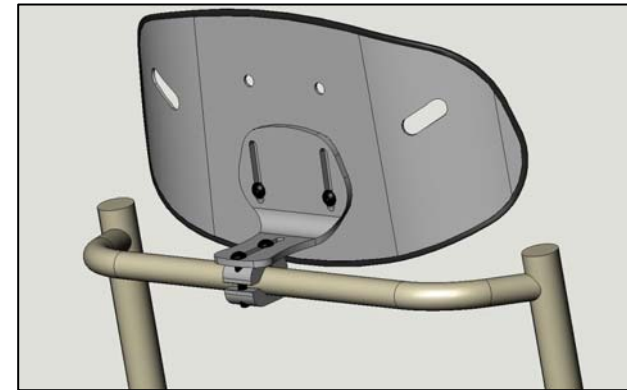
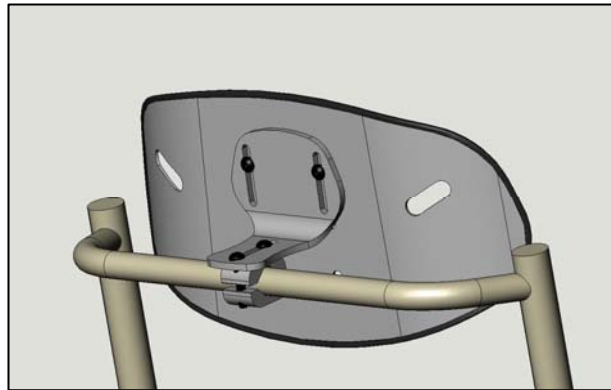
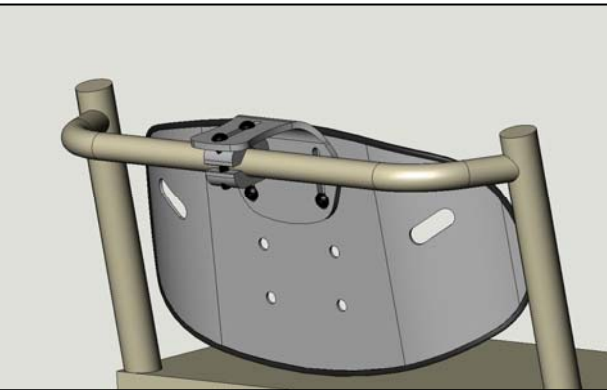

Wide range of vertical adjustment to accommodate rigidizer bar height

Back Angle

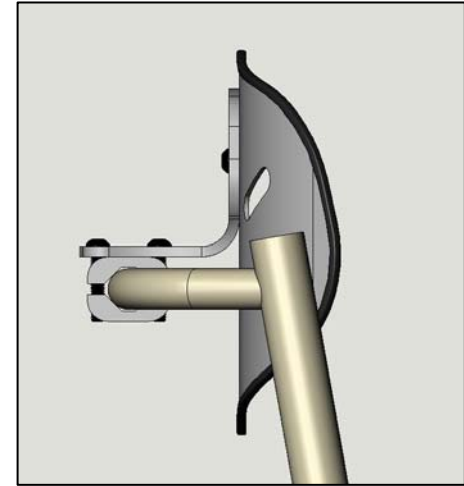
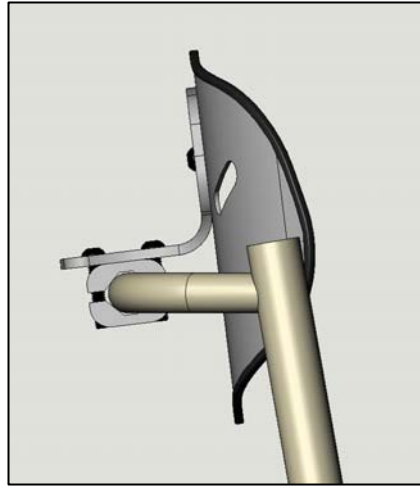
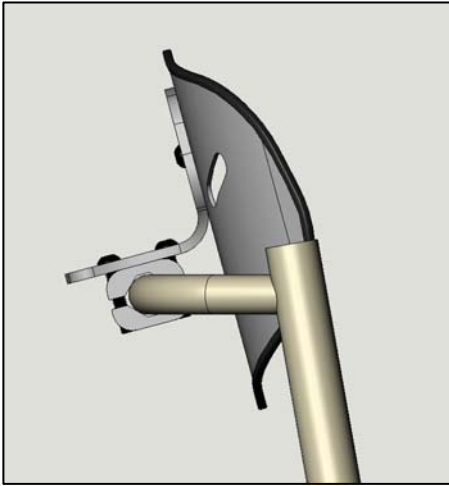

Angle adjustment around stabilizer bar

Bracket Attachment

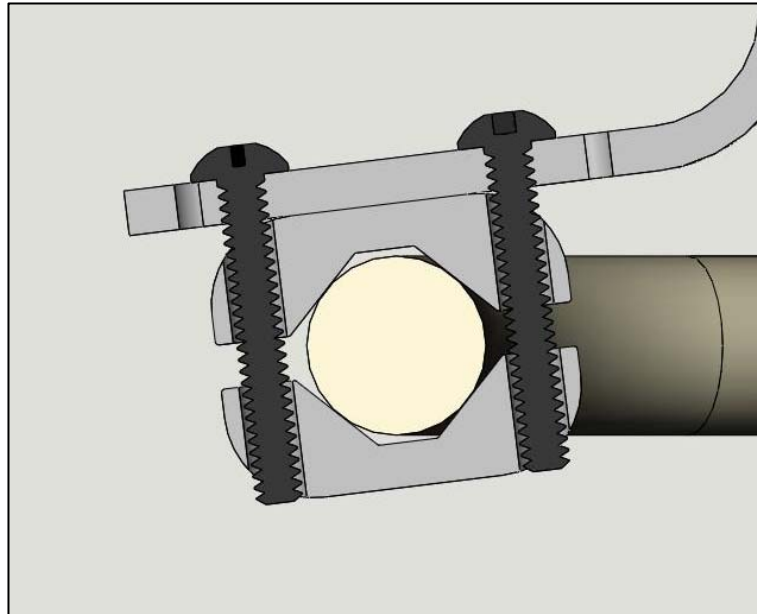

Shape of clamp provides extra contact to eliminate slippage

Brackets

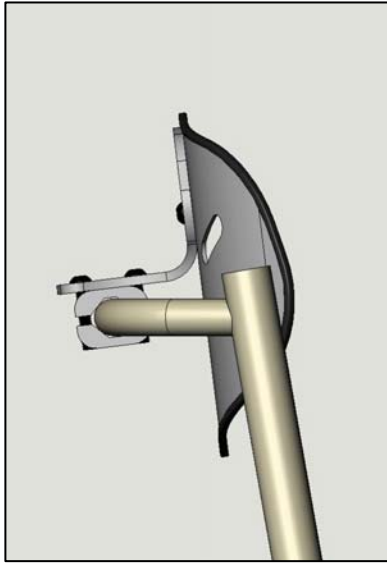

short

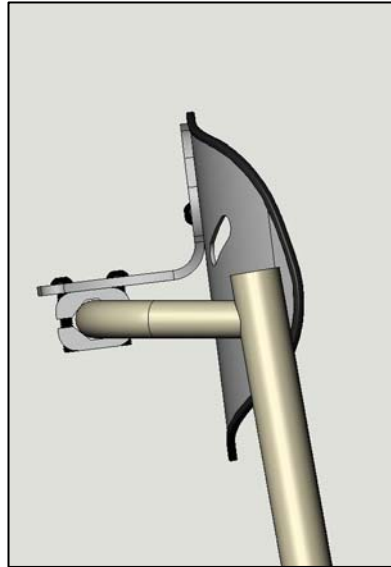

medium

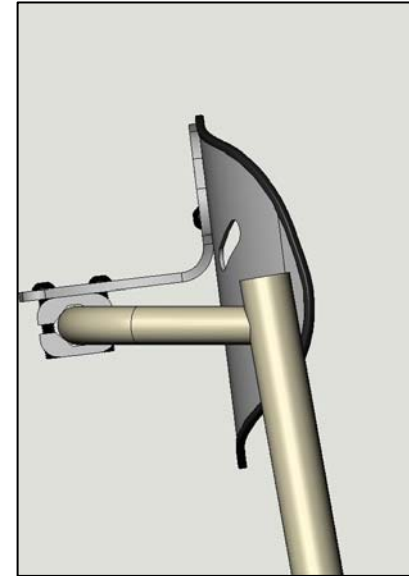

long

Different brackets for different chairs

Why the rigidizer bar?

- Independent of back canes
- Capture the **p**osterior **s**uperior **i**liac **s**pine (PSIS)
- Promotes natural spinal curves
- It looks cool!



What is “stabilizer bar depth”?

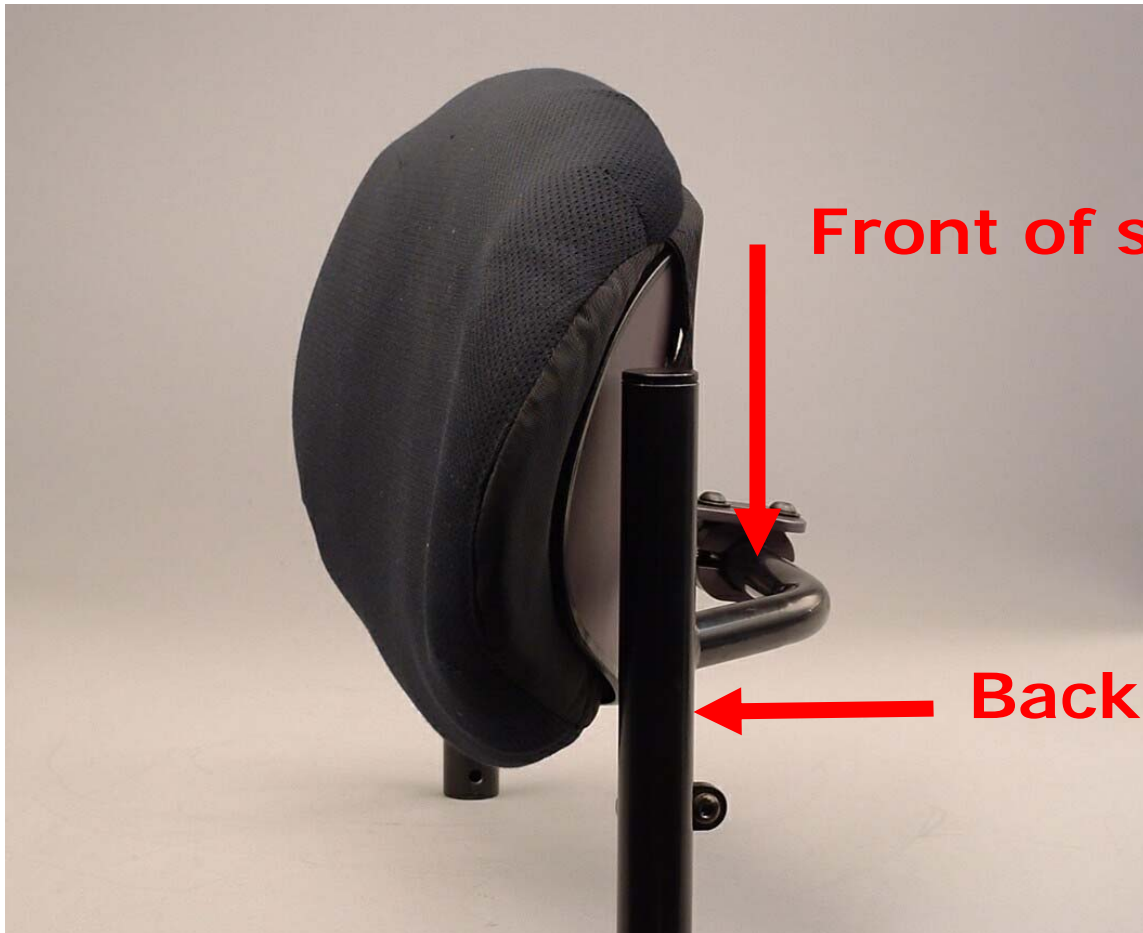

Front of stabilizer bar

Back of back cane



Corresponding bar depths & bracket sizes

Stabilizer bar depth	Bracket size
0" to 2"	Short (47532)
2" to 2.5"	Medium (47533)
2.5" to 3.25"	Long (47534)

Talon Shell

- Constructed of lightweight aluminum
- Brushed to look like titanium
- Oval shaped for maximum support
- Contoured for lateral support
- Low profile for upper body freedom of movement





Talon Back Cushion

- Air-Foam Floatation
- 2 way valve
- 4 way stretch fabric is puncture and moisture resistant
- Oversized



Talon Back Cover

- Mesh cover
- Hook and loop around handle
- Reticulated foam inside
- Machine washable



Talon

- Back system of choice for clients requiring minimal trunk support
- Fully adjustable
- Easy to mount
- Extremely lightweight

